

F.S. NOTES

SPRINKLER SYSTEM

1. SINCE THE TOTAL AREAS OF THIS LICENSE APPLICATION IS NOT EXCEEDING 230 SQUARE METER. SPRINKLER SYSTEM SHALL NOT BE PROVIDED.

FIRE ALARM SYSTEM

2. FIRE ALARM SYSTEM SHALL BE PROVIDED IN ACCORDANCE WITH BS 5839-1:2017 AND THE FSD CIRCULAR LETTER NO. 6/2021.

3. A MANUALLY OPERATED FIRE ALARM SYSTEM SHALL BE PROVIDED FOR LICENSE AREA OF ENTRANCE.

VISUAL FIRE ALARM SYSTEM

4. VISUAL FIRE ALARMS SHALL BE PROVIDED IN ACCORDANCE WITH BS 5839-1:2017, THE FSD CIRCULAR LETTER NO. 2/2012 AND FOLLOW THE DESIGN MANUAL: BARRIER FREE ACCESS 2008 PUBLISHED BY THE BUILDINGS DEPARTMENT.

5. VISUAL FIRE ALARM TO BE PROVIDED AND BE LOCATED AT A PROMINENT LOCATION IN PLACES WHICH ARE INTENDED TO BE ACCESSIBLE TO THE PUBLIC.

HOSE REEL SYSTEM

6. HOSE REEL SYSTEM SHALL BE PROVIDED IN ACCORDANCE WITH THE CODE OF PRACTICE FOR MINIMUM FIRE SERVICE INSTALLATIONS AND EQUIPMENT 2022.

7. HOSE REEL SYSTEM SHALL BE PROVIDED FOR WHOLE BUILDING.

8. THERE ARE SUFFICIENT HOSE REEL TO ENSURE THAT EVERY PART OF THE BUILDING CAN BE REACHED BY A LENGTH OF NOT MORE THAN 30M OF HOSE REEL TUBING.

9. HOSE REEL PUMPS (ON DUTY AND STANDBY) SHALL BE PROVIDED FOR HOSE REEL SYSTEM.

10. A 2000 LITERS HOSE REEL WATER TANK SHALL BE PROVIDED TO SERVE HOSE REEL SYSTEM.

EMERGENCY LIGHTING

12. EMERGENCY LIGHTING SHALL BE PROVIDED IN ACCORDANCE WITH BS 5266-1:2016, BS EN 1838:2013 AND THE FSD CIRCULAR LETTER NO. 5/2008.

13. EMERGENCY LIGHTING SHALL BE PROVIDED IN EVERY COMPARTMENT TO REACH G/F.

EXIT SIGN AND DIRECTIONAL SIGN

14. i. SUFFICIENT DIRECTIONAL AND EXIT SIGNS SHALL BE PROVIDED IN ACCORDANCE WITH BS 5266-1:2016 AND THE FSD CIRCULAR LETTER NO. 5/2008; AND

ii. THE LOCATION OF ALL PROPOSED FSIs, PARTICULARLY THE EMERGENCY LIGHTING TO BE INSTALLED IN EVERY COMPARTMENT ON G/F SHOULD BE CLEARLY INDICATED ON THE LAYOUT PLANS.

POTABLE EQUIPMENT

15. PORTABLE FIRE EXTINGUISHERS SHALL BE PROVIDED AT E POSITION AS SHOWN ON PLANS.

FIRE DETECTION SYSTEM

16. FIRE DETECTION SYSTEM SHALL BE PROVIDED IN ACCORDANCE WITH BS 5839-1:2017 AND THE FSD CIRCULAR LETTER NO. 6/2021.

17. SMOKE DETECTOR WITH SOUNDER BASE SHALL BE PROVIDED IN SLEEPING ACCOMMODATION OF LICENSE AREA.

18. THE DETECTOR SHALL BE OF FSD APPROVED TYPE.

19. ON MAIN FIRE ALARM CONTROL PANEL SHALL BE PROVIDED AS INDICATED ON PLANS TO RECEIVE ALL FIRE ALARM SIGNALS.

20. HEAT DETECTOR SHALL BE PROVIDED FOR LAVATORY AND SMOKE DETECTOR SHALL BE PROVIDED FOR LIVING ROOM AND CORRIDOR.

21. ALL FIRE ALARM SIGNALS INCLUDED FIRE DETECTORS, MANUAL FIRE ALARM CALL POINT SHALL BE LINKED TO FSD COMMUNICATION CENTRE VIA DIRECT LINE PROVIDED BY THE AUTHORIZED SERVICE SERVICE PROVIDER OF THE COMPUTERIZED FIRE ALARM TRANSMISSION SYSTEM.

22. IN ADDITION THE APPLICANT IS ADVISED THAT LICENSING REQUIREMENTS WOULD BE FORMULATED, UPON RECEIPT OF FORMAL VIA THE LICENSING AUTHORITY.

LEGEND

|  |  |  |                      |
|--|--|--|----------------------|
|  | LICENSE AREA                               |  | FIRE HOSE REEL       |
|  | SMOKE DETECTOR                             |  | GATE VALVE           |
|  | SMOKE DETECTOR WITH SOUNDER BASE           |  | CHECK VALVE          |
|  | HEAT DETECTOR                              |  | FLEXIBLE CONNECTOR   |
|  | REMOTE INDICATION LAMP                     |  | Y-TYPE STRAINER      |
|  | REMOTE INDICATION LAMP (WEATHERPROOF TYPE) |  | BALL FLOAT VALVE     |
|  | VISUAL FIRE ALARM                          |  | STRAINER             |
|  | EMERGENCY LIGHTING WITH BACKUP BATTERY     |  | CHECK METER POSITION |

|  |                                    |  |                               |
|--|------------------------------------|--|-------------------------------|
|  | 5KG DRY POWDER FIRE EXTINGUISHER   |  | PRESSURE GAUGE C/W BALL VALVE |
|  | 9L WATER TYPE FIRE EXTINGUISHER    |  | PRESSURE SWITCH               |
|  | 5KG CO2 GAS TYPE FIRE EXTINGUISHER |  | AUTOMATIC AIR VENT            |
|  | EXIT SIGN BOX                      |  | LEVEL FLOAT SWITCH            |
|  | DIRECTIONAL SIGN BOX               |  | MANUAL FIRE ALARM CALL POINT  |
|  | FIRE ALARM BELL                    |  | F.S. CONTROL PANEL            |
|  | MASTER FIRE ALARM BELL             |  | HOSE REEL PUMP                |
|  | MONITOR MODULE                     |  | CONTROL MODULE                |

| COLOUR CODE FOR PIPE SIZES: |             |
|-----------------------------|-------------|
| PIPE SIZE                   | COLOUR CODE |
| 25mm diameter               | GREEN       |
| 40mm diameter               | PURPLE      |
| 50mm diameter               | YELLOW      |

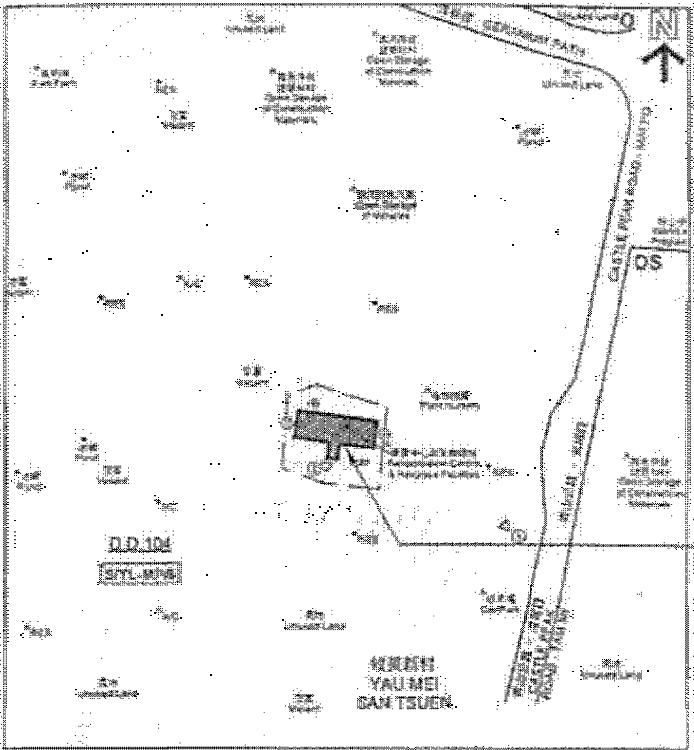

BLOCK PLAN

ABBREVIATION

|     |                           |        |                    |
|-----|---------------------------|--------|--------------------|
| L/L | LOW LEVEL                 | F.E.   | FIRE EXTINGUISHER  |
| H/L | HIGH LEVEL                | F.S.   | FIRE SERVICES      |
| FSD | FIRE SERVICES DEPARTMENT  | S.S.   | STAINLESS STEEL    |
| WSD | WATER SUPPLIES DEPARTMENT | H.R.   | HOSE REEL          |
| COP | CODE OF PRACTICE          | A.A.V. | AUTOMATIC AIR VENT |
| T/A | TO ABOVE                  |        |                    |
| T/B | TO BELOW                  |        |                    |
| F/A | FROM ABOVE                |        |                    |

|                                 |                             |   |   |     |           |         |                |                       |
|---------------------------------|-----------------------------|---|---|-----|-----------|---------|----------------|-----------------------|
| FSI CONTRACTOR:<br><br>WING KAI | CLIENT:<br>MISSION ARK LTD. | PROJECT:<br>元朗米埔丈量約份<br>第104約地段 第4620號1樓<br>(關臨時社會福利設施藥物倚賴者治療及康復中心) | TITLE:<br>F.S. NOTES, LEGEND, BLOCK PLAN,<br>ABBREVIATION AND COLOUR CODE<br>FOR PIPE SIZES | R3  | REVISED   | 06/2024 | SCALE: NTS     | JOB NO.:<br>WK230927  |
|                                 |                             |   |   | R2  | REVISED   | 12/2023 | DRAWN: CAD     |                       |
|                                 |                             |   |   | R1  | REVISED   | 09/2023 | CHECKED: CK HO | DRAWING NO.:<br>FS-01 |
|                                 |                             |   |   | NO. | REVISIONS | DATE:   | BY             |                       |
|                                 |                             |   |   |     |           |         |                |                       |

TO OPERATE FIRE HOSE REEL  
使用消防喉轆

1) ACTIVATE FIRE ALARM CALL POINT  
按動火警鈴聲

2) OPEN CONTROL VALVE BEFORE RUNNING OUT HOSE  
先開喉轆水口, 再拉出喉轆

3) TURN ON WATER AT NOZZLE AND DIRECT JET AT BASE OF FIRE  
將喉轆水口開動, 將水噴向火之基座  
(NOT SUITABLE FOR ELECTRICAL FIRES)  
不適用於電器火

消防用水  
USE OF WATER FROM FIRE SERVICES FOR PURPOSES  
OTHER THAN FIRE FIGHTING IS STRICTLY PROHIBITED

嚴禁作其他用途  
OTHER THAN FIRE FIGHTING IS STRICTLY PROHIBITED

水務監督辦事處  
OFFICE OF THE WATER AUTHORITY

DETAIL OF HOSE REEL OPERATION INSTRUCTION PLATE

HOSE REEL DRUM  
ALARM BELL  
OPERATION INSTRUCTION PLATE FOR HOSE REEL AND WARNING PLATE FOR WATER USAGE  
GLASS FRONTED CABINET WITH LOCK FOR NOZZLE  
A METAL OR PLASTIC STRIKER ABOUT 300MM LONG TO BE PROVIDED INSIDE THE CABINET FOR THE PURPOSE OF BREAKING THE GLASS PANEL IN CASE OF EMERGENCY

PRESSURE SWITCH (FOR F.S. PUMP OUTPUT) (STAND-BY)  
PRESSURE SWITCH (FOR NO FLOW)  
TO DRAIN

DETAIL OF PRESSURE SWITCH ASSEMBLY

F.S. CHECK METER CABINET CONSTRUCTED BY S.S. ANGLE FRAME AND WIRE MESH  
50mm CHECK METER POSITION FOR H.R. SYSTEM  
DETAIL OF F.S. WATER METER CABINET  
PLAN  
ELEVATION

DETAIL OF CHECK METER CABINET

FS PUMP SCHEDULE

|                                 | TYPE OF PUMP                 | FLOW RATE (l/min) | PRESSURE (bar) | MOTOR SPEED (RPM) | POWER RATING (kW) |
|---------------------------------|------------------------------|-------------------|----------------|-------------------|-------------------|
| HOSE REEL PUMP<br>FP-01 & FP-02 | MULTI-STAGE<br>VERTICAL TYPE | 60                | 5              | 2900              | 1.5               |

FOR DETAILS, PLEASE REFER TO TYPICAL DETAIL OF PRESSURE SWITCH ASSEMBLY

FS PUMP CABINET

2000 LITRES FIBREGLASS HOSE REEL WATER TANK

SCALE : N.T.S.

FSI CONTRACTOR:  
 WING KAI ENG. CO.

CLIENT:  
MISSION ARK LTD.

PROJECT:  
元朗米埔丈量約份  
第104約地段 第4620號1樓  
(關臨時社會福利設施藥物倚賴者治療及康復中心)

TITLE:  
SCHEMATIC PIPING DIAGRAM FOR  
HOSE REEL SYSTEM AND PUMP SCHEDULE

|     |           |          |                |                    |
|-----|-----------|----------|----------------|--------------------|
| R3  | REVISED   | 06/2024  | SCALE: NTS     | JOB NO.: WK230927  |
| R2  | REVISED   | 12/2023  | DRAWN: CAD     |                    |
| R1  | REVISED   | 09/2023  | CHECKED: CK HO | DRAWING NO.: FS-02 |
| NO. | REVISIONS | DATE: BY | DATE:          |                    |

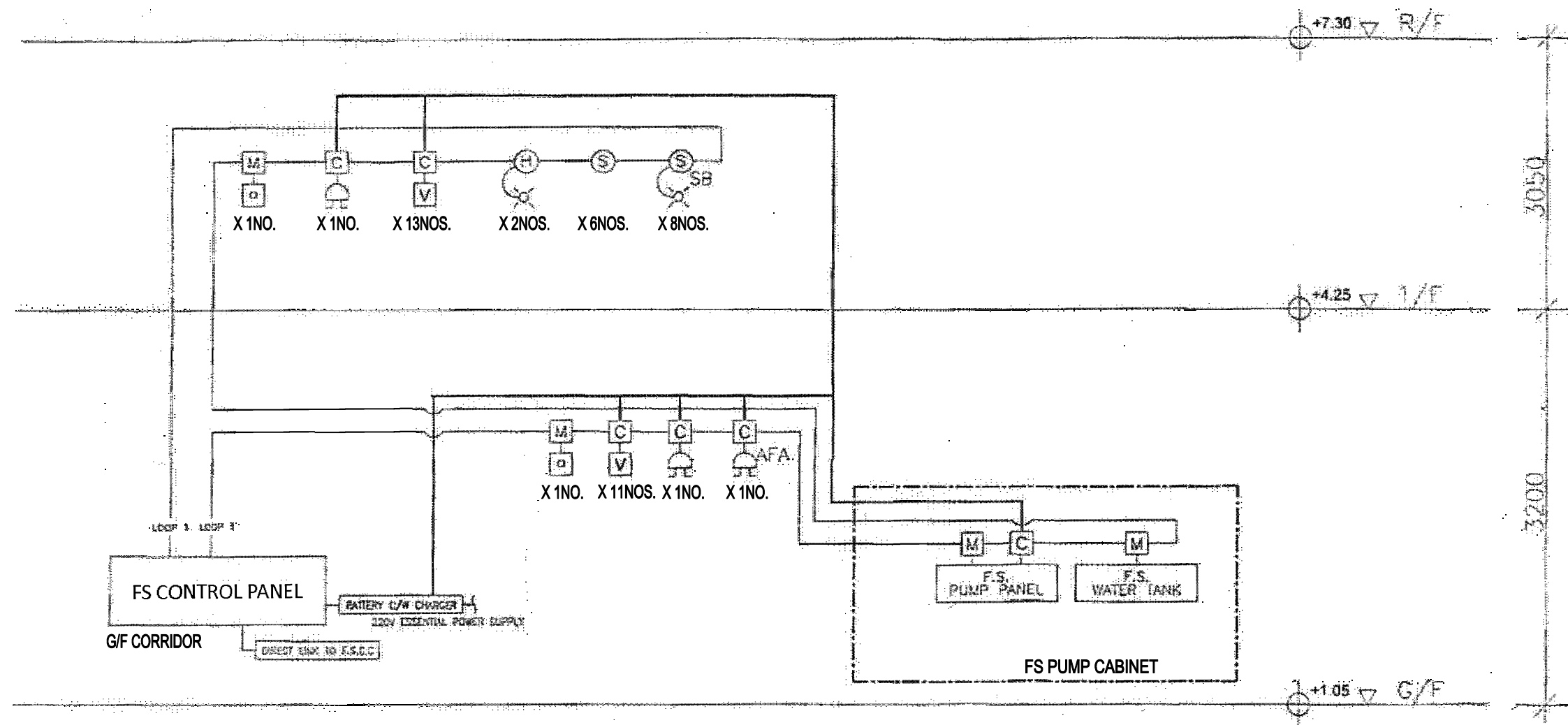

**SCHEMATIC CONTROL WIRING DIAGRAM FOR FIRE ALARM SYSTEM**  
SCALE : N.T.S.

FSI CONTRACTOR:



WING KAI ENG CO.

CLIENT:

MISSION ARK LTD.

PROJECT:

元朗米埔丈量約份  
第104約地段 第4620號1樓  
(關臨時社會福利設施藥物倚賴者治療及康復中心)

TITLE:

SCHEMATIC CONTROL WIRING DIAGRAM  
FOR FIRE ALARM SYSTEM

|     |           |         |                |                    |
|-----|-----------|---------|----------------|--------------------|
| R3  | REVISED   | 06/2024 | SCALE: NTS     | JOB NO.: WK230927  |
| R2  | REVISED   | 12/2023 | DRAWN: CAD     |                    |
| R1  | REVISED   | 09/2023 | CHECKED: CK HO | DRAWING NO.: FS-03 |
| NO. | REVISIONS | DATE:   | BY             | DATE:              |



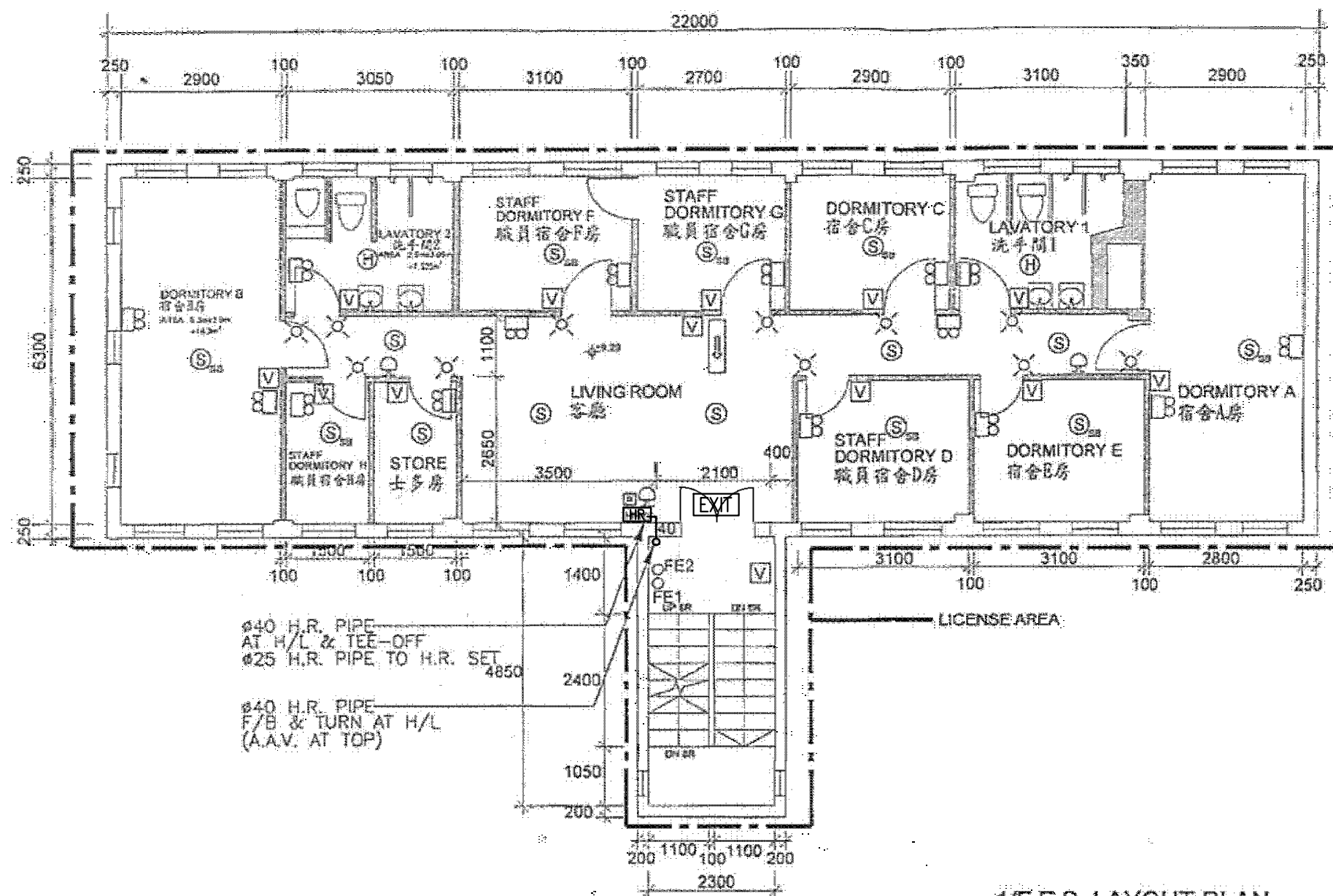

1/F F.S. LAYOUT PLAN

TOTAL FLOOR AREA : (22m x 6.3m) + (4.85m x 2.3m)  
= 138.6m<sup>2</sup> + 11.155m<sup>2</sup>  
= 149.755m<sup>2</sup>

CONCLUSION, TOTAL LICENSE FLOOR AREA IS 149.755m<sup>2</sup>,  
WHICH IS LESS THAN 230m<sup>2</sup>.  
THEREFOR NO SPRINKLER SYSTEM IS REQUIRED.

FSI CONTRACTOR:



WING KAI ENG. CO.

CLIENT:

MISSION ARK LTD.

PROJECT:

元朗米埔丈量約份  
第104約地段 第4620號1樓  
(關臨時社會福利設施藥物倚賴者治療及康復中心)

TITLE:

F.S. LAYOUT PLAN FOR FIRST FLOOR

|     |           |         |                |                    |
|-----|-----------|---------|----------------|--------------------|
| R3  | REVISED   | 06/2024 | SCALE: 1:100   | JOB NO.: WK230927  |
| R2  | REVISED   | 12/2023 | DRAWN: CAD     |                    |
| R1  | REVISED   | 09/2023 | CHECKED: CK HO | DRAWING NO.: FS-05 |
| NO. | REVISIONS | DATE:   | BY             | DATE:              |